

ITEM NO.	QTY.	PART NO.	DESCRIPTION
1	1	8342	CLOTH CHAIN COVER-24 LINK-20"
2	2	9076	HOG RING

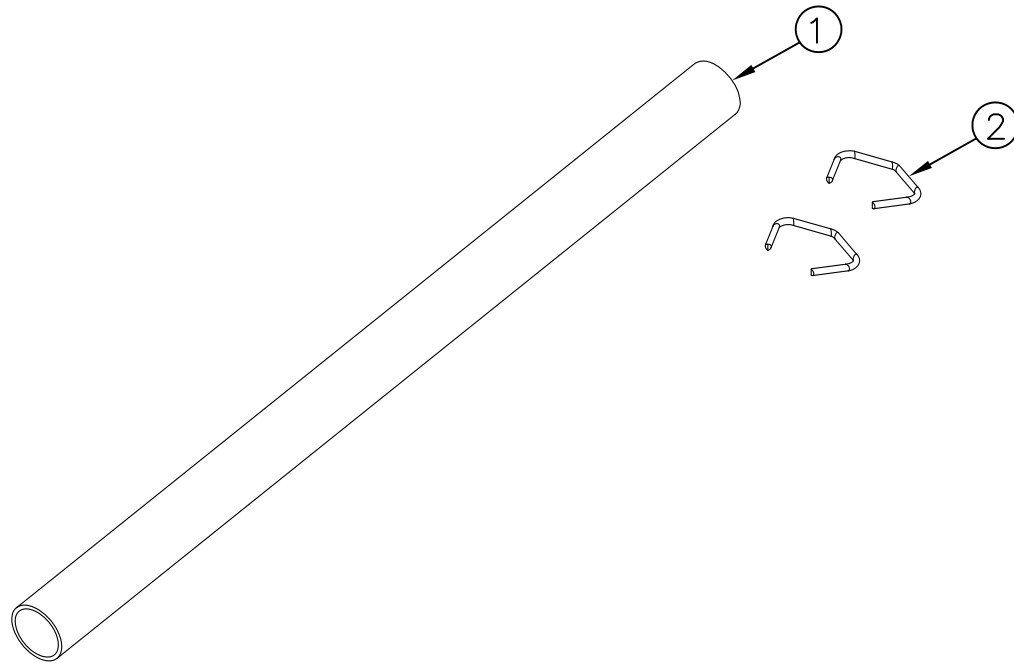

						THIRD ANGLE PROJECTION	FILENAME: E:\KITS(Repair Parts)\G2\006514.dwg	WOODBINE MFG. CO. BUS BROWN DRIVE WOODBINE, IOWA 51579
							SYMBOLY PER ANSI Y14.5	NOTES:
						DECIMAL 2PLC 3PLC	DRAWN BY. MTC	712-647-2050
						MACHINE SAW, DRILL .030 .015	DRAWN/DATE 3/1/07	THE INFORMATION HERE IS CONFIDENTIAL AND MUST NOT BE USED IN ANYWAY DETRIMENTAL TO THE INTEREST OF WOODBINE MFG.
A.1	3/16/16	UPDATED DESCRIPTION TO 20"	AAS			SHEAR, PUNCH FORM .060 .030	APPVD/DATE 3/1/07	
A	3/1/07	DRAWN IN AUTOCAD	MTC	KGJ		TORCH, WELDING ROUGH CAST .090 .060	TITLE REPLACEMENT CLOTH CHAIN COVER 20"	
REV.	DATE	CHANGE RECORD	BY	APPVD	ECN	DRAFT 2'	SALES CATEGORY 45	PRODUCT LINE 1249
						ANGULAR ±1'	SCALE N	FIN. WT. 1.74
							PART NO. 6514	