

ITEM NO.	QTY.	PART NO.	DESCRIPTION
1	1	013278	1/4"x48" HYD HOSE-04MORB X 04FJIC
2	1	012958	#4 FORB TO #6 MALE NPT ADAPTOR
3	1	012957	#4 MJIC TO #4 MALE NPT ADAPTOR

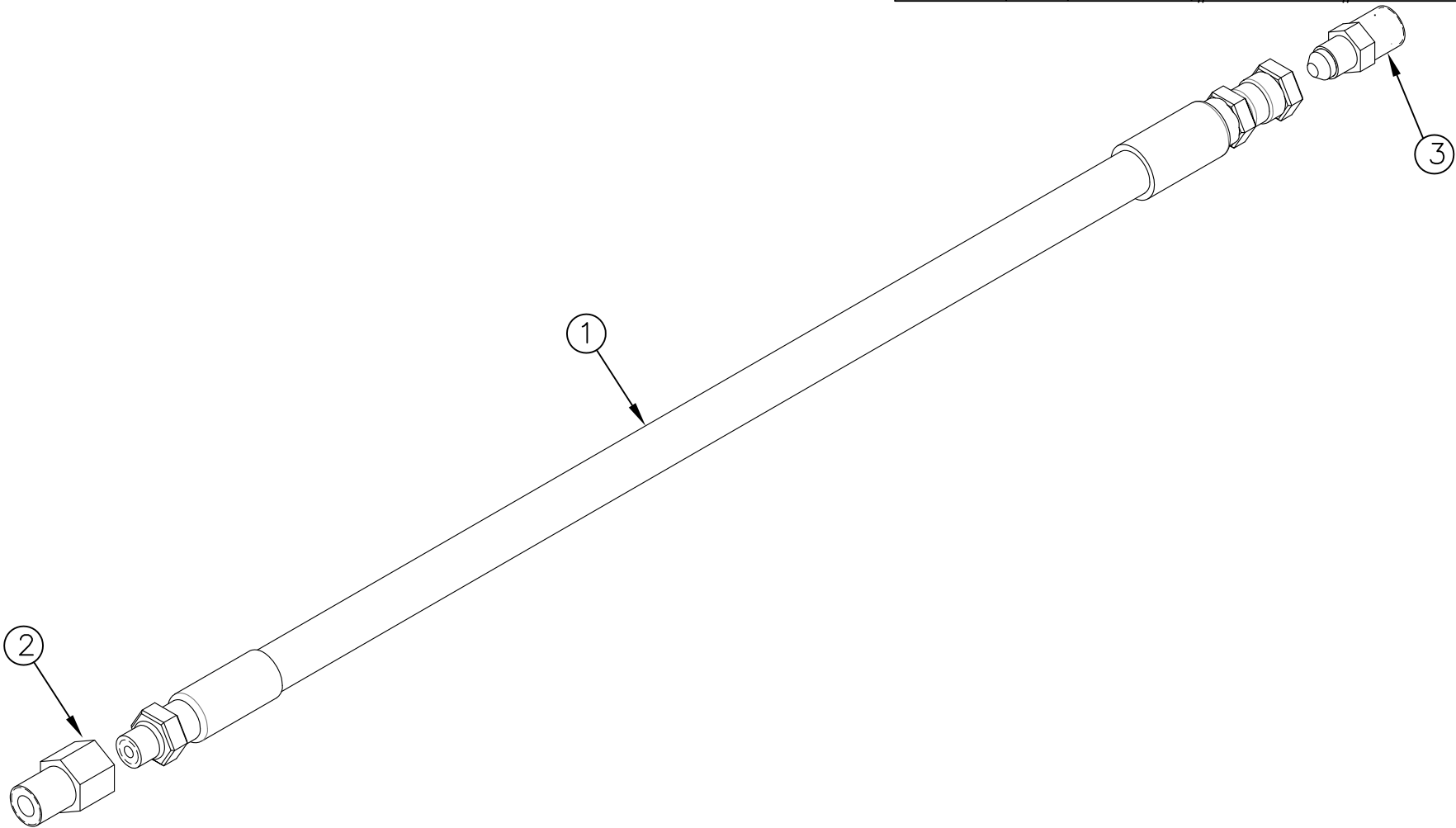

				THIRD ANGLE PROJECTION			FILENAME:		WOODBINE MFG. CO.															
							SYMBOLY PER ANSI Y14.5		BUS BROWN DRIVE															
				<table border="1"> <thead> <tr> <th>DECIMAL</th> <th>2PLC</th> <th>3PLC</th> </tr> </thead> <tbody> <tr> <td>MACHINE SAW, DRILL</td> <td>.030</td> <td>.015</td> </tr> <tr> <td>SHEAR, PUNCH FORM</td> <td>.060</td> <td>.030</td> </tr> <tr> <td>TORCH, WELDING ROUGH CAST</td> <td>.090</td> <td>.060</td> </tr> </tbody> </table>			DECIMAL	2PLC	3PLC	MACHINE SAW, DRILL	.030	.015	SHEAR, PUNCH FORM	.060	.030	TORCH, WELDING ROUGH CAST	.090	.060	DRAWN BY. GDB		NOTES:		WOODBINE, IOWA 51579	
DECIMAL	2PLC	3PLC																						
MACHINE SAW, DRILL	.030	.015																						
SHEAR, PUNCH FORM	.060	.030																						
TORCH, WELDING ROUGH CAST	.090	.060																						
							DRAWN/DATE 11/12/13		712-647-2050															
							APPVD/DATE																	
A 11/12/13 RELEASED TO PRODUCTION				GDB 1004			TITLE		THE INFORMATION HERE IS CONFIDENTIAL AND MUST NOT BE USED IN ANYWAY DETRIMENTAL TO THE INTEREST OF WOODBINE MFG.															
CHANGE RECORD				BY APPVD ECN			SALES CATEGORY		REPLACEMENT 1/4" X 48" HYDRAULIC HOSE (50" CABLE)															
				DRAFT 2'			ANGULAR ±1'		SCALE N															
							FIN. WT.		PART NO. 012960															