

ITEM NO.	QTY.	PART NO.	DESCRIPTION
1	1	010248	BELTING 8" X 26-1/4" G2-50 LND
2	1	010249	10GA X 1" X 25.188" BACKING STRIP
3	5	010252	1/4-20x1" PHI FH TYPE F SS
4	5	000532	1/4-20 USS CROWN LOCK NUT

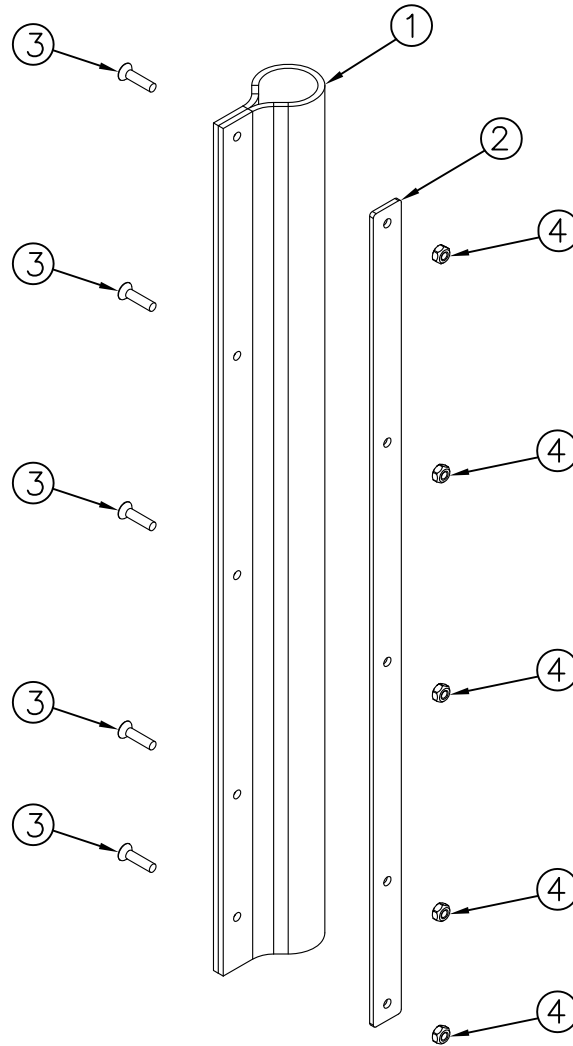

						THIRD ANGLE PROJECTION	FILENAME:	WOODBINE MFG. CO. BUS BROWN DRIVE WOODBINE, IOWA 51579
							SYMBOLY PER ANSI Y14.5	NOTES:
						DECIMAL	2PLC	3PLC
						MACHINE SAW, DRILL	.030	.015
						SHEAR, PUNCH FORM	.060	.030
						TORCH, WELDING ROUGH CAST	.090	.060
A	1/25/10	DRAWN IN AUTOCAD	JCB	259			DRAWN BY: JCB	DRAWN/DATE 1/25/10
REV.	DATE	CHANGE RECORD	BY	APPVD	ECN	DRAFT 2*	ANGULAR ±1*	APPVD/DATE
							SALES CATEGORY	TITLE REPLACEMENT G2 LD SUB ASSEMBLY SEAL BELTING KIT
							PRODUCT LINE	SCALE 1:4
								FIN. WT. 2.39
								PART NO. 10466

712-647-2050



THE INFORMATION HERE IS CONFIDENTIAL AND MUST NOT BE USED IN ANYWAY DETRIMENTAL TO THE INTEREST OF WOODBINE MFG.